



Project: JSWD Architekten

Urban Regeneration of Bologna's Former Fruit and Vegetable Market

Trilogia Navile is a system of 3 coordinated architectural complexes which form part of the macro-project for the **regeneration of the former fruit and vegetable market** in the Navile area of Bologna (one of the largest regeneration projects in the city covering a surface area of about 30 hectares). Situated **a few hundred metres from the city centre, within walking distance from the railway and future High Speed station** designed by the architect Arata Isozaki, the area will include an extensive park, public offices such as the municipal administration and the local health authority, a 200-space multi-storey car park, a kindergarten, an elementary school, a day nursery, a hostel serving the university and sports centres.

The regeneration project was designed in partnership with the neighbourhood's inhabitants through "participatory urban planning". For the architectural development of the plots of land of its own property, **Valdadige Costruzioni** organized an international competition that was participated by 5 internationally renowned architects' firms: Cino Zucchi Architetti, O.A.B. Carlos Ferrater, BIURO PROJEKTOW LEWICKI LATAK, ARTECO&Architetti Associati and JSWD ARCHITEKTEN.

The tender was won by **Cino Zucchi Architetti**, who will design all residential and office buildings and some public office buildings, and **JSWD ARCHITEKTEN**, who will design the public office building opposite Bologna's new railway station.

The area owned by Valdadige comprises five plots (C, D, E, M, P) for a total buildable area of 55,000 sqm.

More specifically, Trilogia Navile consists of:

- Navile 1: Multi-purpose commercial, office and residential buildings for a total surface area of **37,300 sqm**
- Navile 2: Residential buildings for a total surface area of **13,500 sqm**
- Navile 3: A predominantly commercial and office building with a total surface area of **4,200 sqm.**

The buildings shall meet high architectural standards with cutting-edge building techniques and measures aimed at minimising energy consumption.



Project: Cino Zucchi Architetti

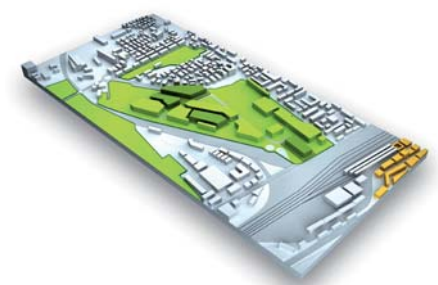

Trilogia Navit

Valdadige Costruzioni's exclusive Casa Ambiente® System

It is a complex and integrated system of design features, building techniques and installations aiming to achieve the highest building standards in the fullest respect of the environment. More than ever before, the construction of a building must comply with two related values: the highest possible standards of comfort for the inhabitants and environmental sustainability. It stands for a home in which excellence and cost saving are essential, and energy consumption and pollutant emissions are kept at a minimum.

BolognaSystem



Project: JSWD Architekten

The Casa Ambiente System offers a comprehensive interpretation of the most innovative building regulations as well as looking forward to future developments, with guaranteed returns on long-term investments with properties that will remain regulation-compliant well into the future. Buildings constructed according to the Casa Ambiente System are certified by Italy's two leading certification bodies, Casaclima of Bolzano and ICMQ of Milan.

Valdadige Group

Valdadige was founded in 1876 and grew rapidly to become one of Italy's leading manufacturers of building components. In the '70s, it expanded its business to become a leader in prefabricated buildings, constructing schools, factories and residential buildings. At the start of the '80s, Valdadige changed its shareholders and expanded into real estate construction and services for the social, public and private sectors. Since the '90s, Valdadige has been expanding also in the entertainment and leisure sectors: its Aquafan and Oltremare parks in Riccione are renowned. With the establishment of Verona Building in Krakow in 2002, the company started expanding in Eastern Europe. Some of its most important projects, both finished and in progress, are: Corte Pancaldo in Verona, a complex of over 20,000 sqm including shops, offices, homes and major urbanisation works; homes along the Martesana, a whole neighbourhood including more than 1,000 homes in Vimodrone, in the south eastern hinterland of Milan, which forms part of a regeneration project which includes a 10-hectare park and a new road system linking it to the East Ring Road of Milan; Rimini & Rimini, a project for the regeneration of the former Murri colony and a one kilometre seafront with car parks and equipped green areas in Rimini; more than one thousand homes in the process of being built in three major Polish cities.



Project: Cino Zucchi Architetti