

Immagine Terraltaly TM-©
Compagnia Generale Riprese Aeree S.p.A. - Parma

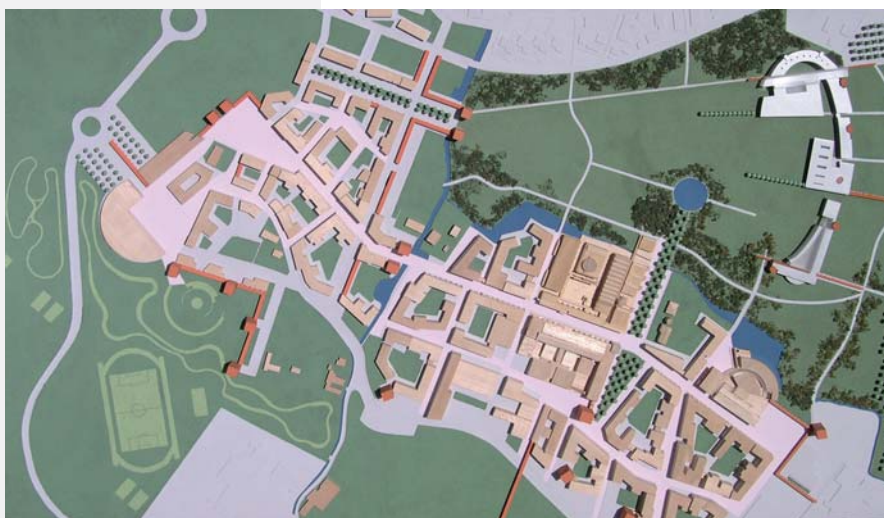

The New Urban University District Bertalia-Lazzaretto

The new district is located to the North-West of the city. It is one of the most important projects for the future development of Bologna and **covers an area of over 730,000 sqm**. It will combine a new university campus with residential buildings, offices, shops, public services and hospitality facilities. The new urban residential complex will accommodate 1,800 units, providing housing for approximately 25,000 people and integrating existing inhabitants with 7,000 students and workers and 5,000 new residents. **The new university campus will cover an area of over 45,000 sqm and will become a new centre of scientific research and innovation.** The area will house the Engineering Faculty, with a recently completed administration block, main conference hall, library and the main buildings of four departments which will be added to the three existing ones. The new development will be less than a kilometre away from the CNR (National Research Council) and the faculties of Biotechnology, Chemistry and Pharmacy, with which new forms of collaboration are expected to develop. The development's quality will be discernible not only in the living standards and the high levels of environmental sustainability, but also by the road and infrastructural system which will make for efficient connections between public (buses, People Mover, tram-subway, Metropolitan Railway System) and private transportation. The Municipal Council and the University of Bologna appointed Finanziaria Bologna Metropolitana the task of running the international design competition for Bertalia-Lazzaretto, which was won by architect Piero Sartogo (with the collaboration of architect Richard Meier and sculptor Arnaldo Pomodoro), as well as the subsequent executive plan.



The project aims to develop a new district in which the centuries-old tradition of integration between the city and its University is considered an added value, refusing the model of a campus cut off from the life of the city. Based on the morphological and relational model, a 'new centrality' will take shape in the form of squares, porticoes and towers, all of which are characteristic elements of the history of Bologna. The connection with the surrounding areas will be provided by a city park affording a large common space complete with sports facilities and cycle-tracks which can be used both by those who already live in the area and the new inhabitants. The process of approving the detailed plan ended in 2007, and the executive phase is now underway with work about to start on the first property unit compartments.

Bertalan Lazzaretto

Total surface area	730,000 sqm
Total building potential	215,050 sqm
Total surface area for residential use	137,995 sqm
Total surface area for lecture halls and engineering faculty departments	44,250 sqm
Total surface area for offices and shops	22,476 sqm
Total surface area for public use	10,329 sqm
Total surface area for public green areas	285,969 sqm
Total surface area for parking	50,561 sqm

BolognaSystem

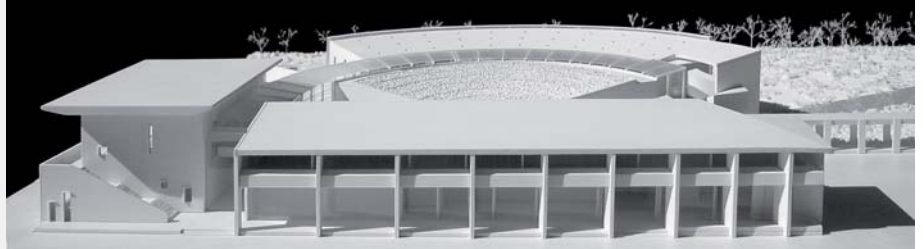
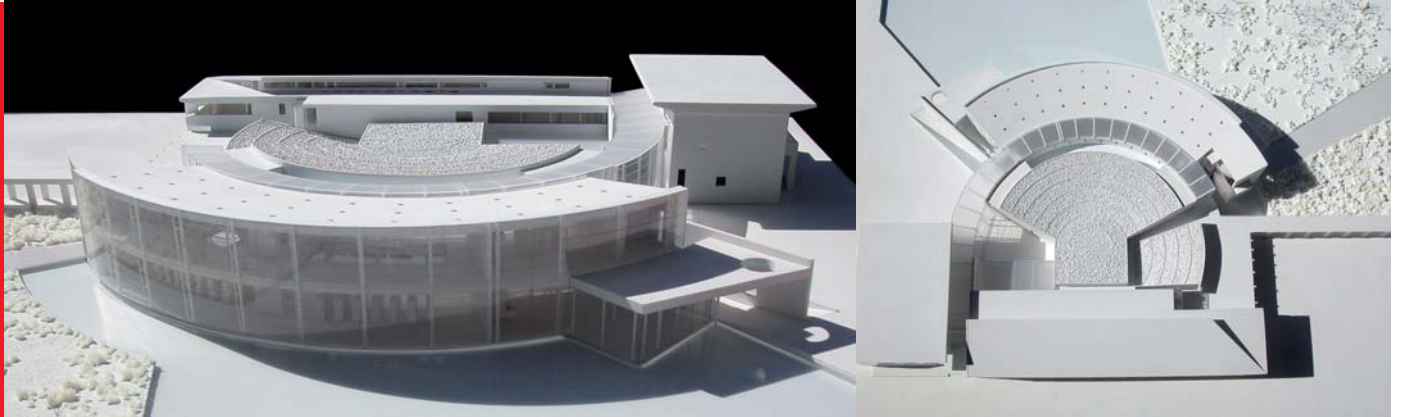

FBM

Finanziaria Bologna Metropolitana (FBM) was set up in 1964 under the name of Finanziaria Fiere di Bologna promoted by the Municipal Council, Province, Chamber of Commerce and the Bologna International Trade Fair Company with the initial aim of providing the city with a new and modern exposition centre and, once built, to study and set up general interest initiatives designed to further the economic development of Bologna's metropolitan area. The company established the fair district's exhibition halls and offices, designed by architect Kenzo Tange, and collaborated on some of the city's most important infrastructural projects, including the CNR (National Research Council) research facility. In 1997, the University of Bologna also joined FBM, using its resources for setting up a new location for the Engineering Department in the Lazzaretto Area and the Chemistry and Astronomy Departments in the Navile area. Among the FBM projects are the completion of the Trade Fair District, with new buildings for the Emilia-Romagna regional government and a new exhibition centre, and the project to requalify the former tobacco factory (Manifattura Tabacchi).

